

FIRST FLOOR

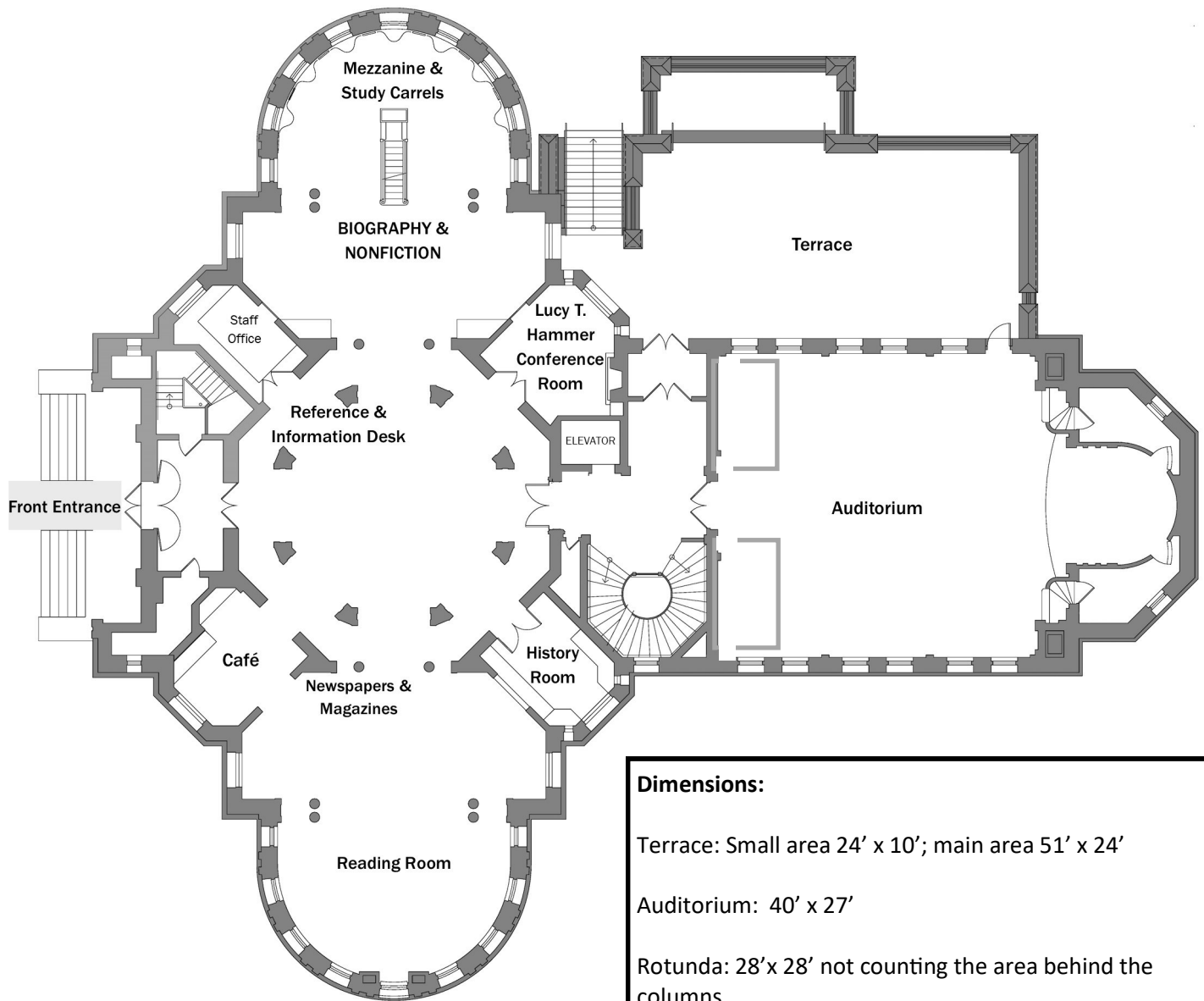

Dimensions:

Terrace: Small area 24' x 10'; main area 51' x 24'

Auditorium: 40' x 27'

Rotunda: 28' x 28' not counting the area behind the columns.

Reading Room: 31' x 36'

Number of parking spaces including front and back lots, plus street = 77

(This includes 9 in the front lot, 34 in the back plus a total of 34 along Laurel and Main Streets.)

